

# R100 Series Reflex Sight Glass Level Gage

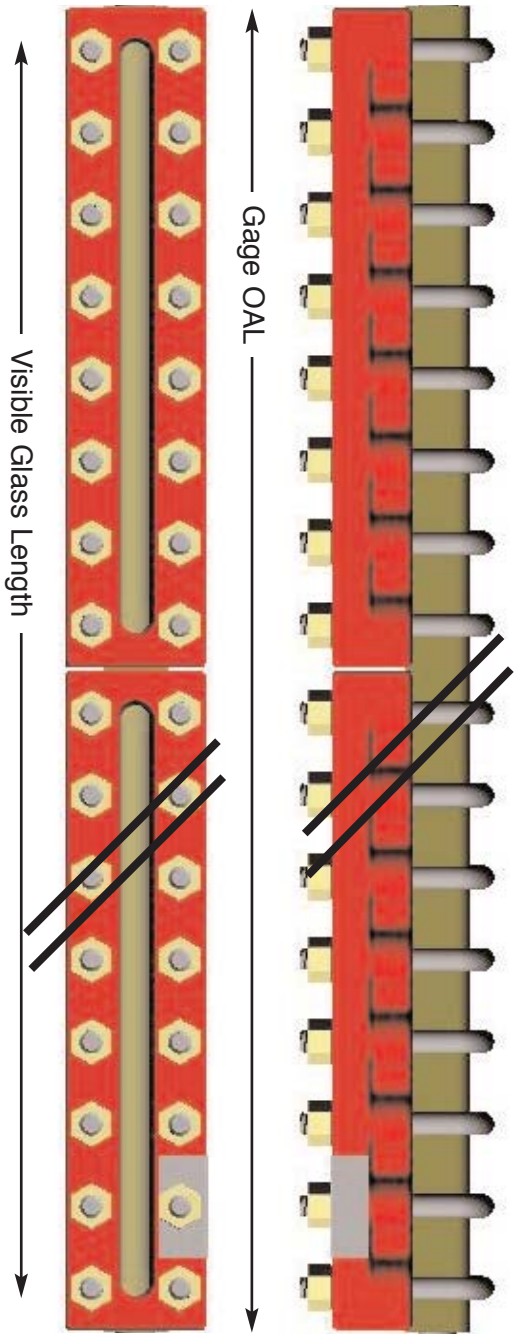

Model No.	Visible Length (In)	Overall Length (In)	Weight (Lbs)	Pressure Ratings (except for Steam), PSI					
				100°F	200° F	300° F	400° F	500° F	600° F
				Max. Recommended Steam Service: 250 WSP or 401°F Superheated					
R100-13	5.75	7.25	12	2810	2720	2620	2520	2330	2090
R100-14	6.75	8.25	13	2710	2640	2540	2440	2270	2010
R100-15	7.875	9.375	14	2630	2550	2450	2360	2190	1950
R100-16	9.125	10.625	16	2540	2450	2370	2280	2100	1870
R100-17	10.25	11.75	18	2440	2370	2280	2200	2020	1800
R100-18	11.875	13.375	20	2340	2280	2200	2110	1950	1730
R100-19	12.625	14.125	21	2250	2190	2100	2030	1870	1670
R100-24	15	16.5	24	2710	2640	2540	2440	2270	2010
R100-25	17.25	18.75	27	2630	2550	2450	2360	2190	1950
R100-26	19.75	21.25	31	2540	2450	2370	2280	2100	1870
R100-27	22	23.5	34	2440	2370	2280	2200	2020	1800
R100-28	25.25	26.75	39	2340	2280	2200	2110	1950	1730
R100-29	26.75	28.25	41	2250	2190	2100	2030	1870	1670
R100-36	30.375	31.875	46	2540	2450	2370	2280	2100	1870
R100-37	33.75	35.25	51	2440	2370	2280	2200	2020	1800
R100-38	38.625	40.125	58	2340	2280	2200	2110	1950	1730
R100-39	40.875	42.375	61	2250	2190	2100	2030	1870	1670
R100-47	45.5	47	68	2440	2370	2280	2200	2020	1800
R100-48	52	53.5	77	2340	2280	2200	2110	1950	1730
R100-49	55	56.5	81	2250	2190	2100	2030	1870	1670
R100-57	57.25	58.75	85	2440	2370	2280	2200	2020	1800
R100-58	65.375	66.875	96	2340	2280	2200	2110	1950	1730
R100-59	69.125	70.625	102	2250	2190	2100	2030	1870	1670
R100-68	78.75	80.25	116	2340	2280	2200	2110	1950	1730
R100-69	83.25	84.75	122	2250	2190	2100	2030	1870	1670
R100-78	92.125	93.625	135	2340	2280	2200	2110	1950	1730
R100-79	97.375	98.875	142	2250	2190	2100	2030	1870	1670
R100-88	105.5	107	154	2340	2280	2200	2110	1950	1730
R100-89	111.5	113	163	2250	2190	2100	2030	1870	1670
R100-98	118.875	120.375	173	2340	2280	2200	2110	1950	1730
R100-99	125.625	127.125	183	2250	2190	2100	2030	1870	1670
R100-108	132.25	133.75	193	2340	2280	2200	2110	1950	1730
R100-109	139.75	141.25	204	2250	2190	2100	2030	1870	1670

Reflex Glass shows **BLACK** in Liquid—  
**SILVERY-WHITE** in steam, gas, or air

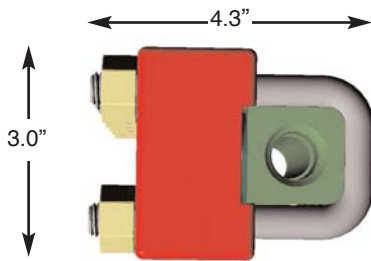

End Connection

- 1/2" F-NPT standard
- 3/4" F-NPT optional

## MATERIALS

- all steel construction
- wetted per NACE
- alloy steel bolting
- tempered borosilicate glass
- non-asbestos seal and cushion gasket
- optional mat'ls available

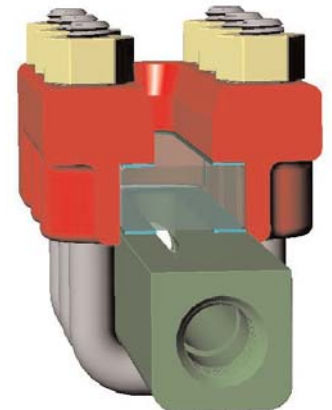

Drawing R100