

Spherical Union Advantages

The Problem:

Irregularities in parallelism of upper & lower vessel nozzles can cause the vessel unions to be out of square.

The two point attachment of a typical sight glass requires simultaneous squareness when making up the unions - otherwise leak at the union or excessive strain of the connector and the "connecting nipples" will result

Spherical Unions... useful for

End Connected Gages - **NO** (except with tee's)

Reason: ball and socket joint does not allow for variation in vessel C-C

Side or Back Connected Gages - **YES**

Recommended for:

- * Angular misalignment
Caused by non-jigset construction, welding distortion, etc
- * **Long and Heavy LG's** and/or Vibration service

Increased bending strength of Spherical Union vessel connector compared to Flat Union vessel connector, 1.57x greater section modulus with standard ± 8 degree rotation design or 1.98x with 4 degree rotation design

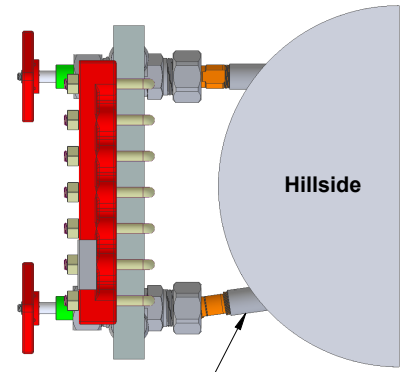
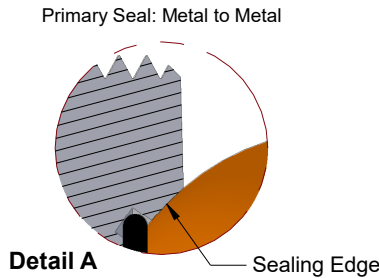
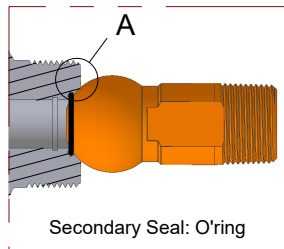
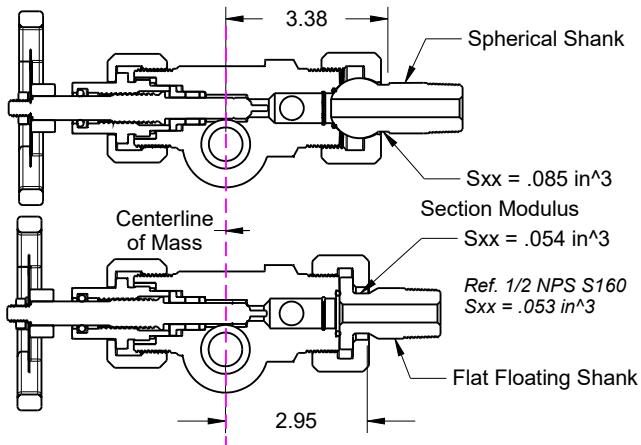

Angular misalignment often seen on horizontal vessels and field constructed piping. Corrected with use of spherical unions - as shown

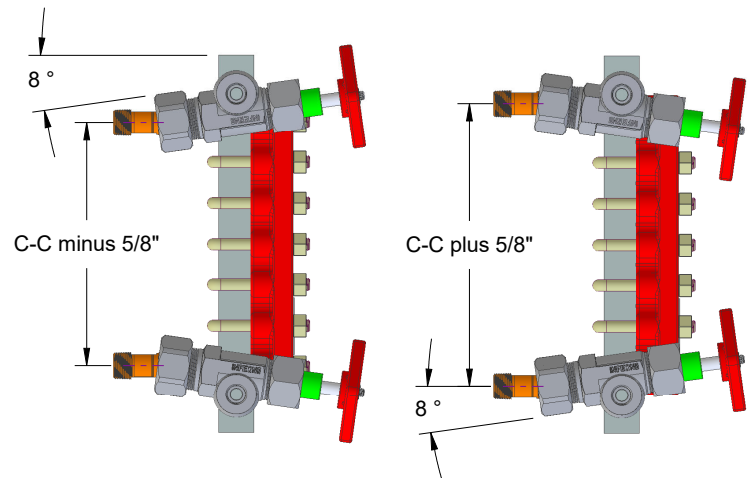
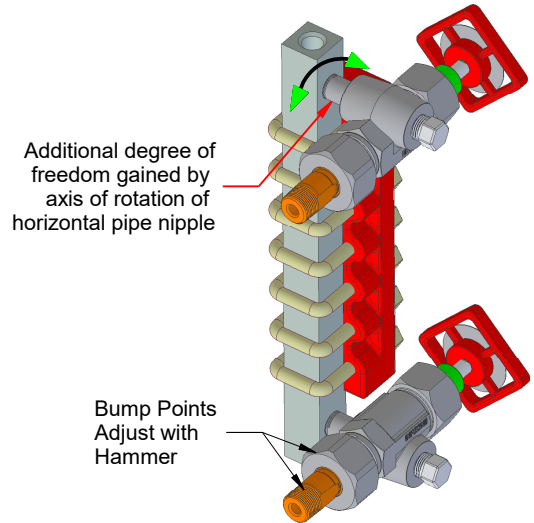

Reference Documents

A202103 Long & Heavy Level Gages

Spherical Union Advantages:

- * Minimize piping strain
- * Minimize leak at union
- * Quicker assembly in the field



Inferno Manufacturing Corporation

115 Ricou St. Shreveport, LA USA 71107

T (318) 221-8454 F (318) 222-4106

inferno@infernomfg.com

Drawing No: **A202102**

Drawing Date: 11/13/2020

Revision: 0

Rev Date: N/A

© 2020 Inferno Mfg Corp

Sheet: 1/1