

Item	Description	Qty	Mat'l	Size	Wetted
1	Sight Tube	1	Borosilicate Glass	5/8" \varnothing 3/32"	Y
2	Upper End Fitting	1	T316 SS	5/8" \varnothing x 1-7/8"	Y
3	Lower End Fitting	1	T316 SS	5/8" \varnothing x 1-1/8"	Y
4	Insert	2	T316 SS	N/A	Y
5	Armor	1	T304 SS	1-1/2" \varnothing	N
6	Jam Nut	2	T304 SS	1-1/2" Hex	N
7	Glass Seal	2	Viton (Std)	2-208	Y
8	Stabilizer	1*	Viton	N/A	N

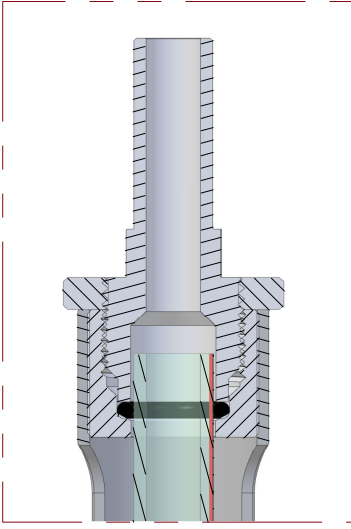

Detail A

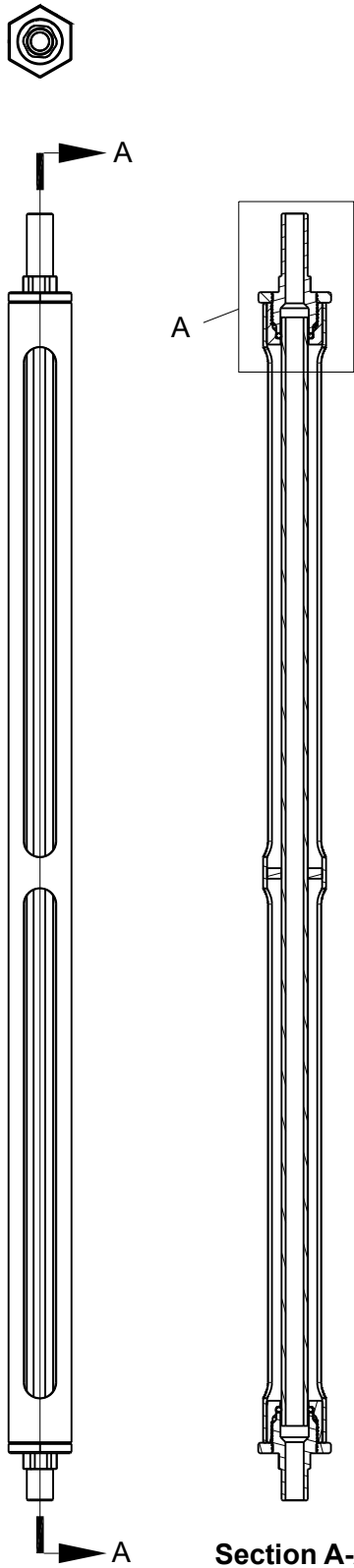
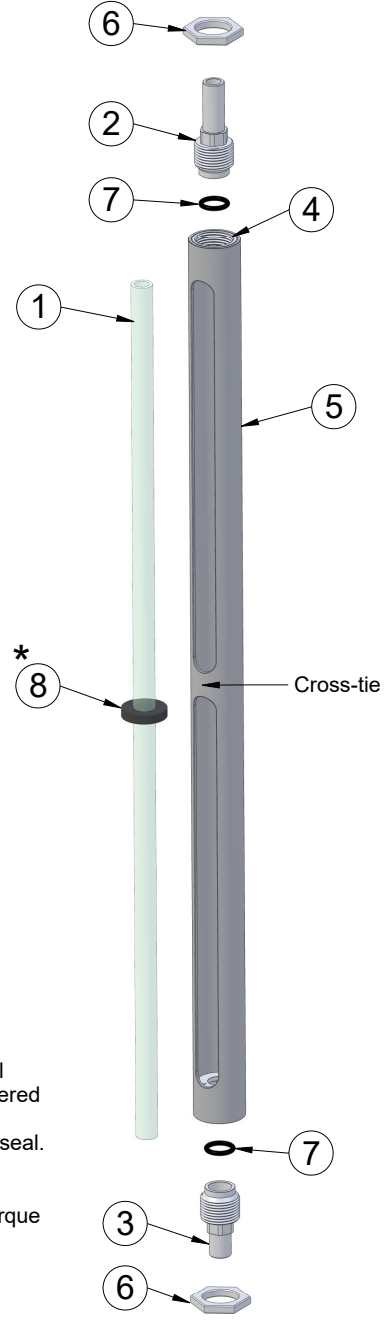

Glass Tube / Glass Seal Replacement Instructions:

1. Remove both Jam Nuts (6) and End Fittings (2 & 3)
2. Push glass tube to break loose from glass seal
3. Remove & inspect glass tube & both glass seals
4. If stabilizer (8) is present, remove & inspect for wear and insert behind cross-tie
5. Install glass tube through armor (5) and stabilizer. Water or alcohol is recommended to lubricate stabilizer for easier assembly
6. Install glass seals on both ends of glass tube and push until seated in bottom of insert (4) while keeping glass tube centered
7. Insert both end fittings and tighten snug to compress glass seal. **DO NOT OVER TORQUE**
8. Place jam nuts over end fittings and tighten snug. Heavy torque not required.

Notes:
1. * (1) stabilizer per cross-tie



Inferno Manufacturing Corporation
115 Ricou St. Shreveport, LA USA 71107
T (318) 221-8454 F (318) 222-4106
inferno@infernomfg.com

**Model TE Gage
Glass Tube & Glass Seal Replacement**

Drawing No: A212220 Aprvd Date: 10/28/2021
Drawing Date: 10/28/2021 Revision: 0
Drawn by: TB Rev Date: N/A
Approved by: AO © 2021 Inferno Mfg Corp