

Close Hook-Up "CH" Style LG

- Close Hook-up design insures the longest possible glass length for a given vessel C-C
- LG chamber elongated to accomodate lateral ports
- Gage valves can be set closer together than a standard end connected gage, within 3/8" of the visible glass dimension, see Table
- Permits use of spherical unions

Irregularities in parallelism of upper & lower vessel nozzles can cause the vessel unions to be out of square. The two point attachment of a typical sight glass requires simultaneous squareness when making up the unions - otherwise leak at the union or excessive strain of the connector and the "connecting nipples" will result

Spherical Union Advantages:

- Minimize piping strain
- Minimize leak at union
- 1.7x stronger in bending than regular Flat Floating Union vessel connector.... more suitable for long and heavy gages

Reference Documents: EN.RT-S5, Eng. Notes M991980, MOC

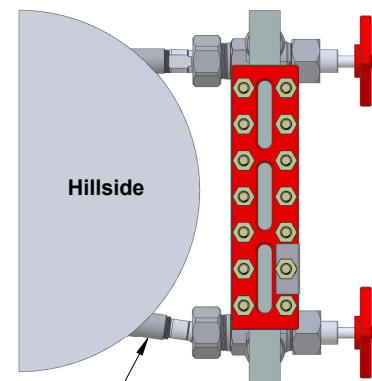

Angular misalignment often seen on horizontal vessels and field constructed piping

Corrected with use of spherical unions - as shown

General Arrangement Drawing
Level Gage & Gage Valve Combo

Transparent Style: T100 / T200
Level Gage, Back Connected
Gage Valves, Single Union: FT15 / 15A
Assembly Orientation: Fig. 5-4-R
Offsets Inside

All dimensions in Inches

Inferno Manufacturing Corporation
115 Ricou St. Shreveport, LA USA 71107
T (318) 221-8454 F (318) 222-4106

<http://www.infernomfg.com/>

inferno@infernomfg.com

Drawing No: **GA.TS5-4-R**

Drawing Date: 7/24/2020

Revision: A

Rev Date: 5/12/2022

© 2020 Inferno Mfg Corp

Sheet: 1/4

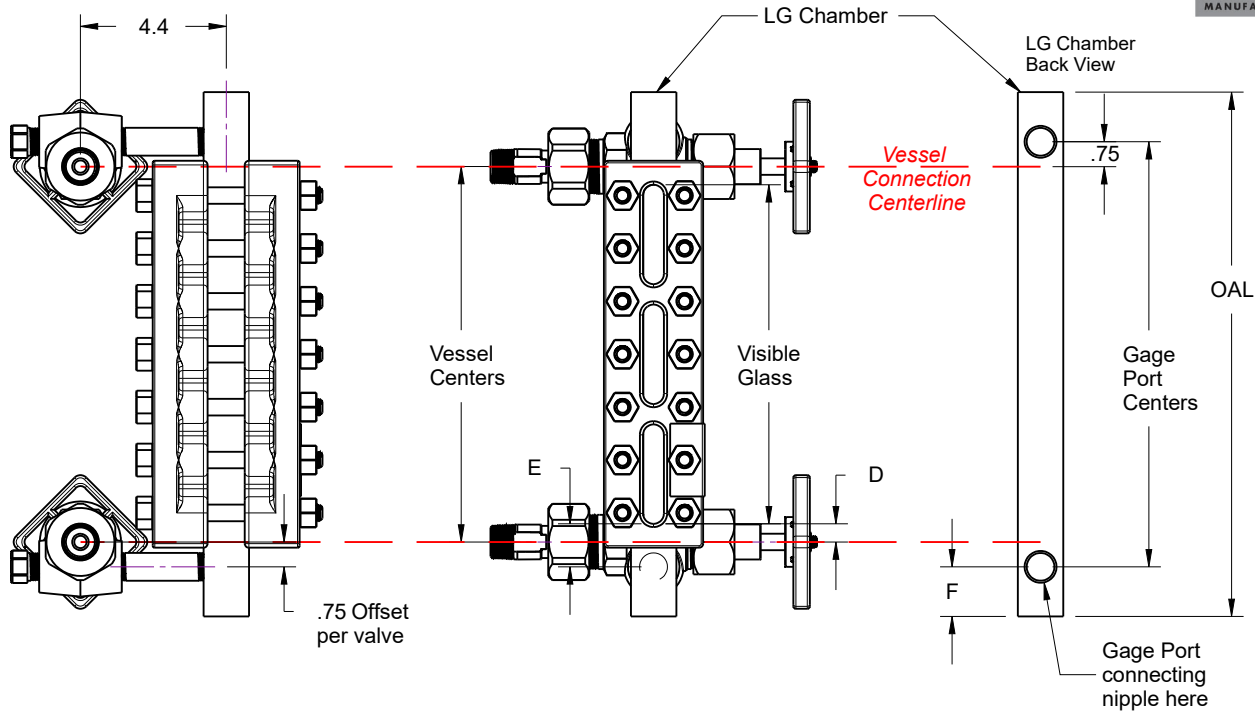

Table - Ref. Fig. 5-4

Gage Port NPS	Minimum Vessel C-C Equals	D = distance from lower glass view to lower vessel C/L	Min. D	Min. Gage Port C-C	E = distance from lower glass view to lower gage port	F
1/2	Visible Glass + 2.5"	(Vessel C-C minus Visible Glass / 2)...or specify asymmetry if required	1.25"	Visible Glass + 4"	Min. 2"	1.5"
3/4						2"

Example: T100-19 CH (21#) ... with 1/2 NPS connecting nipples

Case A, Typical arrangement: mounted on 16" vessel centers ...
 $D = (16 - 12.625 \text{ vis. glass}) / 2 = 1.688"$

Case B, Factory minimum - Catalog standard: design vessel nozzles at 15.125" C-C... $D = (15.125 - 12.625 \text{ vis. glass}) / 2 = 1.25"$

Offsets Inside

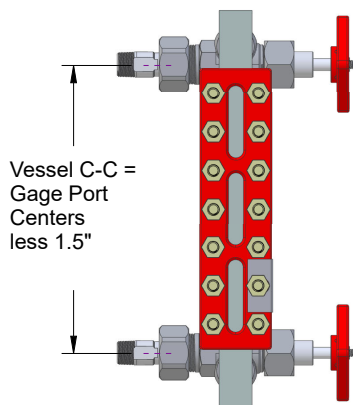

Offsets Outside

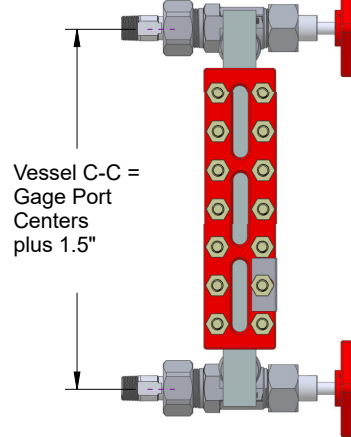

Offsets Parallel

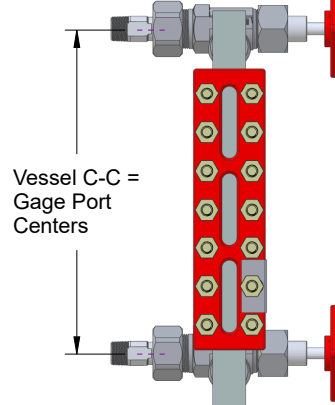

Special Side / End Connected

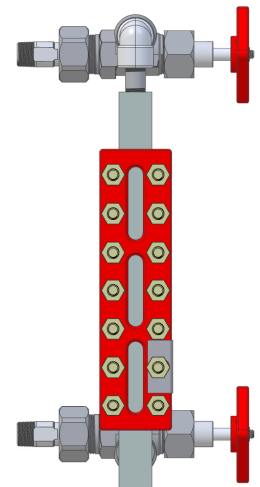

General Arrangement Drawing
 Level Gage & Gage Valve Combo

Transparent Style: T100 / T200
 Level Gage, Back Connected
 Gage Valves, Single Union: FT15 / 15A
 Assembly Orientation: Fig. 5-4-R
 Offsets Inside

All dimensions in Inches

Inferno Manufacturing Corporation
 115 Ricou St. Shreveport, LA USA 71107
 T (318) 221-8454 F (318) 222-4106

<http://www.infernomfg.com/>

inferno@infernomfg.com

Drawing No: **GA.TS5-4-R**

Drawing Date: 7/24/2020

Revision: A

Rev Date: 5/12/2022

© 2020 Inferno Mfg Corp

Sheet: 2/4

Choice of Vessel Union Connector

3/8" inside diameter flow path

FLAT / FLOATING UNION

Linear Adjustment

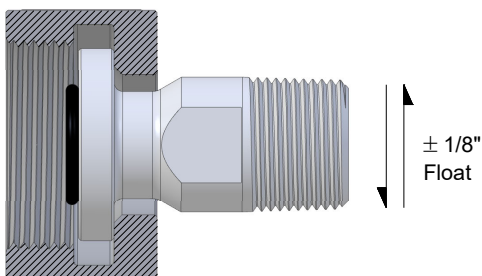

Permits up to 1/4" on vessel centers (pair)

SPHERICAL UNION

Angular Adjustment

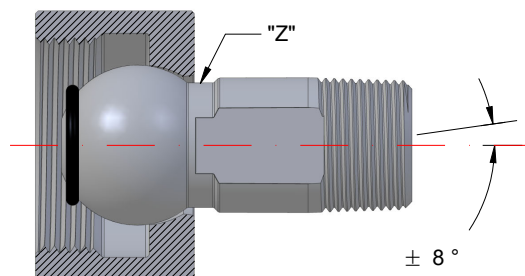

Larger section modulus "Z" than FLAT floating union connector, 1.7x stronger in bending

Recommended for angular misalignment due to non-jig set construction, vibration service, & long / heavy gages

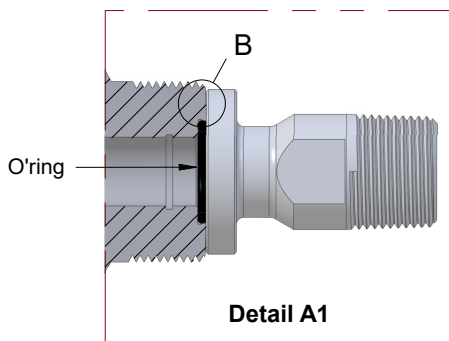

Soft Seal: Static O'ring
Standard feature

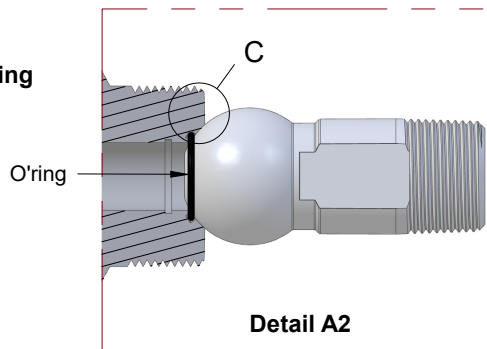

Union Nut omitted for clarity

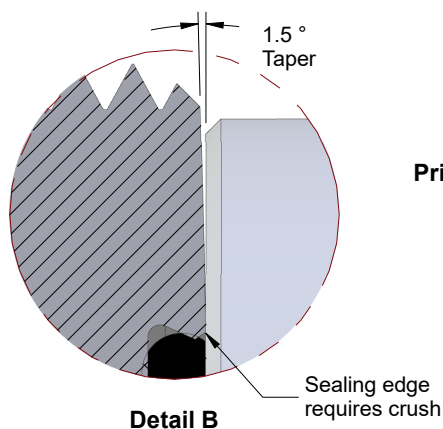

Primary Seal: Metal to Metal
O'ring not required

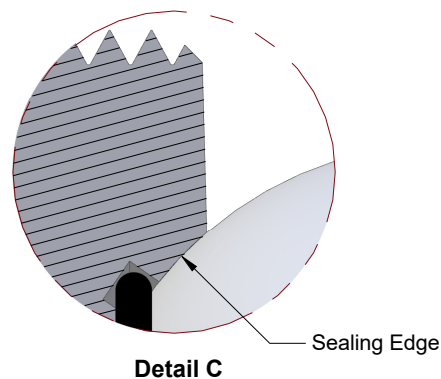

General Arrangement Drawing
Level Gage & Gage Valve Combo

Transparent Style: T100 / T200
Level Gage, Back Connected
Gage Valves, Single Union: FT15 / 15A
Assembly Orientation: Fig. 5-4-R
Offsets Inside

All dimensions in Inches

Inferno Manufacturing Corporation

115 Ricou St. Shreveport, LA USA 71107
T (318) 221-8454 F (318) 222-4106

<http://www.infernomfg.com/>

inferno@infernomfg.com

Drawing No: **GA.TS5-4-R**

Drawing Date: 7/24/2020

Revision: A

Rev Date: 5/12/2022

© 2020 Inferno Mfg Corp

Sheet: 3/4

Center to Center Adjustment using Spherical Unions



Vessel connectors remain parallel after rotation

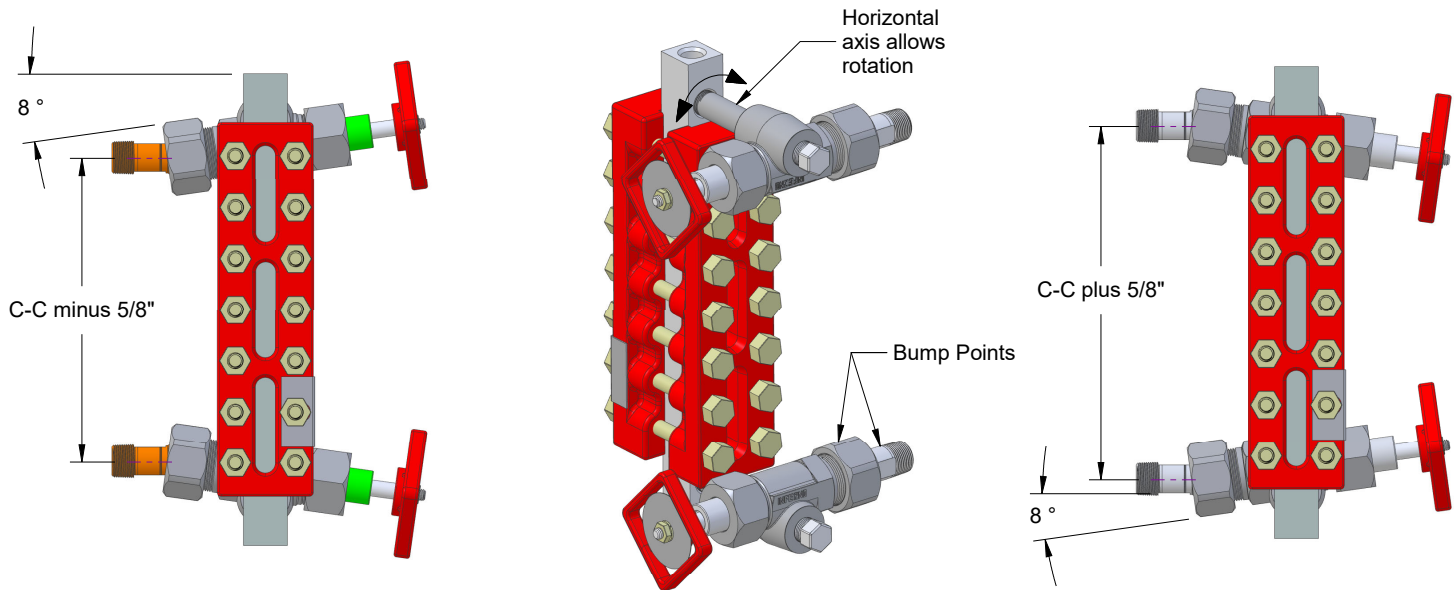

If required, use a soft hammer to "bump" the spherical union vessel connector into "rotated" position.

Note: the horizontal connecting axis between LG and GV permits use of spherical union, which will overcome both angular AND vessel C-C misalignment at the same time.

Gage Port Options

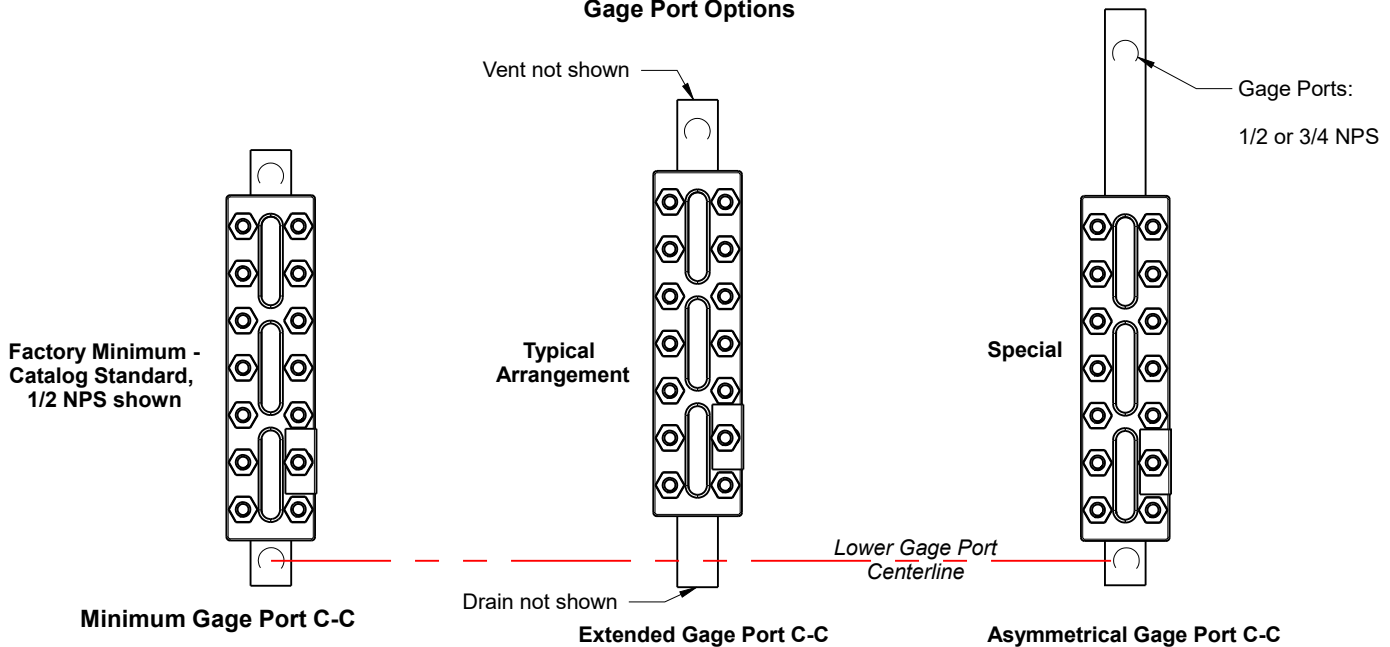

Design vessel C-C distance using Table 1... where
Vessel C-C = Visible Glass (1/2 NPS), or
Vessel C-C = Visible Glass + .375" (3/4 NPS)

Factory customized to match
vessel centers

General Arrangement Drawing
Level Gage & Gage Valve Combo

Transparent Style: T100 / T200
Level Gage, Back Connected
Gage Valves, Single Union: FT15 / 15A
Assembly Orientation: Fig. 5-4-R
Offsets Inside

All dimensions in Inches

Inferno Manufacturing Corporation
115 Ricou St. Shreveport, LA USA 71107
T (318) 221-8454 F (318) 222-4106

<http://www.infernomfg.com/>

inferno@infernomfg.com

Drawing No: **GA.TS5-4-R**

Drawing Date: 7/24/2020

Revision: A

Rev Date: 5/12/2022

© 2020 Inferno Mfg Corp

Sheet: 4/4