

T100 Series Level Gage— See-Thru (Transparent / Plain) Style for Liquid-Liquid INTERFACE or Liquid-Vapor applications

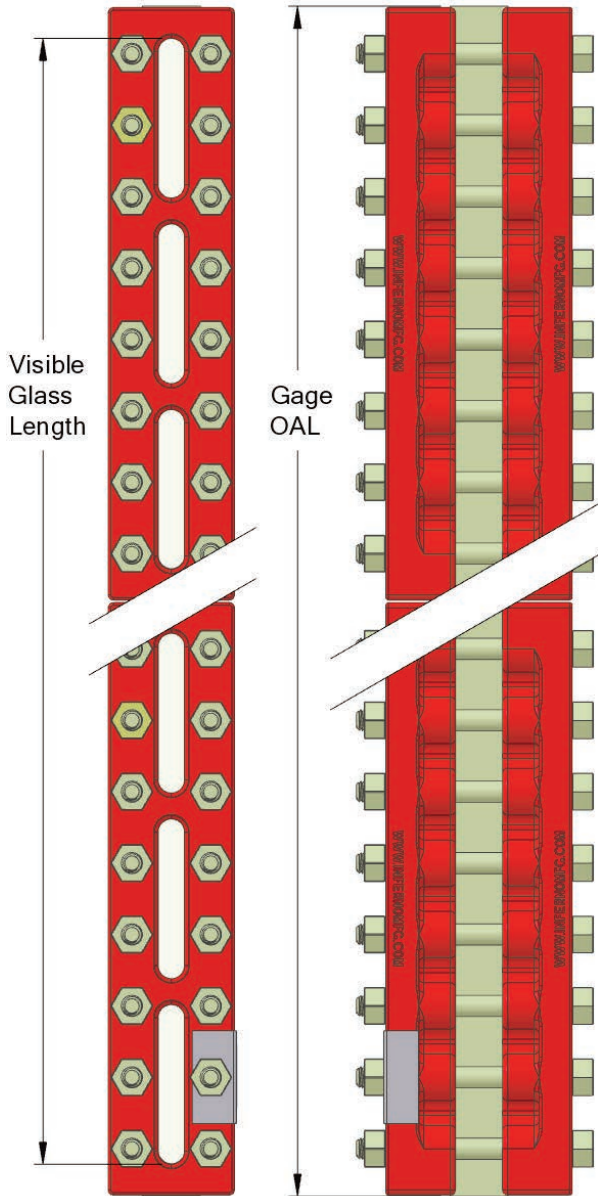

Model No. Visible Length Overall Length * Weight

* OAL and Illustrations pertain to "End Connected" type only. OAL for Close Hook-Up, "CH" type gages is longer and depends on Center-to-Center

	(In)	(In)	(Lbs)
T100-13	5.75	7.25	17
T100-14	6.75	8.25	19
T100-15	7.875	9.375	21
T100-16	9.125	10.625	24
T100-17	10.25	11.75	27
T100-18	11.875	13.375	30
T100-19	12.625	14.125	32
T100-24	15	16.5	38
T100-25	17.25	18.75	43
T100-26	19.75	21.25	49
T100-27	22	23.5	53
T100-28	25.25	26.75	61
T100-29	26.75	28.25	64
T100-36	30.375	31.875	73
T100-37	33.75	35.25	80
T100-38	38.625	40.125	91
T100-39	40.875	42.375	96
T100-47	45.5	47	107
T100-48	52	53.5	121
T100-49	55	56.5	128
T100-57	57.25	58.75	133
T100-58	65.375	66.875	152
T100-59	69.125	70.625	160
T100-68	78.75	80.25	182
T100-69	83.25	84.75	192
T100-78	92.125	93.625	212
T100-79	97.375	98.875	224
T100-88	105.5	107	243
T100-89	111.5	113	256
T100-98	118.875	120.375	273
T100-99	125.625	127.125	288
T100-108	132.25	133.75	303
T100-109	139.75	141.25	320
T100-118	145.625	147.125	330
T100-119	153.875	155.375	352
T100-128	159	160.5	360

Pressure Ratings, PSI factory hydrotested to 1.3 x						
Exception: Steam Service limited to 450 WSP (457°F Superheated) with MICA PROTECTION, 250 WSP unprotected						
100°F	200° F	300° F	400° F	500° F	572° F	
2130	2060	1990	1900	1770	1650	
1950	1880	1820	1730	1620	1430	
1750	1700	1640	1570	1460	1300	
1560	1510	1460	1400	1300	1160	
1380	1330	1280	1230	1200	1020	
1200	1150	1102	1070	990	880	
1000	970	930	890	830	750	
1950	1880	1820	1730	1620	1430	
1750	1700	1640	1570	1460	1300	
1560	1510	1460	1400	1300	1160	
1380	1330	1280	1230	1200	1020	
1200	1150	1102	1070	990	880	
1000	970	930	890	830	750	
1380	1330	1280	1230	1200	1020	
1200	1150	1102	1070	990	880	
1000	970	930	890	830	750	
1380	1330	1280	1230	1200	1020	
1200	1150	1102	1070	990	880	
1000	970	930	890	830	750	
1200	1150	1102	1070	990	880	
1000	970	930	890	830	750	
1200	1150	1102	1070	990	880	
1000	970	930	890	830	750	
1200	1150	1102	1070	990	880	
1000	970	930	890	830	750	
1200	1150	1102	1070	990	880	
1000	970	930	890	830	750	
1200	1150	1102	1070	990	880	
1000	970	930	890	830	750	

Maximum continuous operating temperature decreased from 600°F to 572°F based on glass manufacturer's published rating for tempered borosilicate.

Exception: Hot oil / thermal transfer fluid applications with borosilicate glass permitted up to 600°F, limited to 145 PSI max.

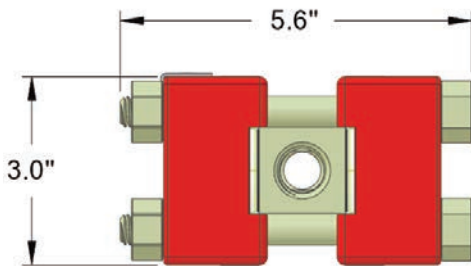

End Connections

- 1/2" F-NPT standard
- 3/4" F-NPT optional

Materials of Construction:

See [M191980](#) for popular options

- Tempered borosilicate glass, Maxos® brand
- Gage body (wetted) per NACE
- Cover flanges, powder coated steel (standard) or stainless
- B7 bolting, zinc plated (standard)
- B7M, de-rate 20%
- B8M Class 2, de-rate 15%
- Flexible graphite seal / compressed fiber cushion
- Cross ties for added strength, undercut permits "behind-the-bar" vision for complete view, design validated by FEA
- Gage support for long / heavy gages (either factory-welded brackets or lift-from-below angle plate)
- Large thru-bore (0.59 Ø) between sections allows brush access for cleaning

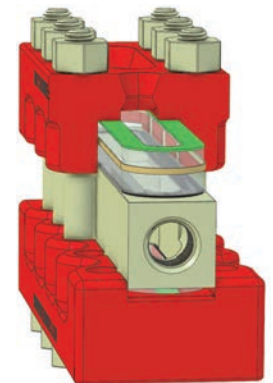

Drawing T100

Revision: E Rev. Date: 5/17/2022

Created: 7/30/2007