

Model FT-TUB-LE

Low Emission / Easy Manual Operation
Rigid Tank Connection - Offset Pattern - Safety Ball Check
For Bare Glass Tubes or Model TE (Armored Tubular Level Gages)

Now available with Fugitive Emission API 622 Valve Stem Packing: Flexible Graphite with NiCr Wire

Certified Performance Class:

ISO FE AM-CO1-SSA 0 - T200C-3000 psig - ISO 15848-1

Tested on methane gas, 3000 PSI @ 392° F, 2 heat / cool cycles,
 no packing adjustment required, < 50 PPMv

Operating Torque: 5 Ft-lbs ...
 operable by hand, no wrench required

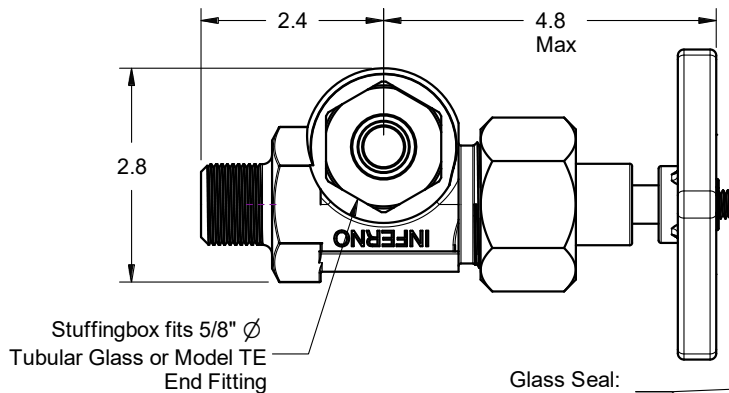
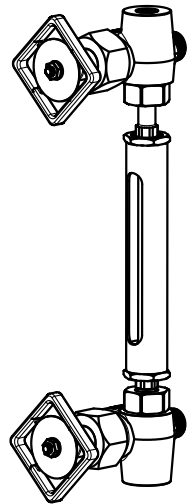
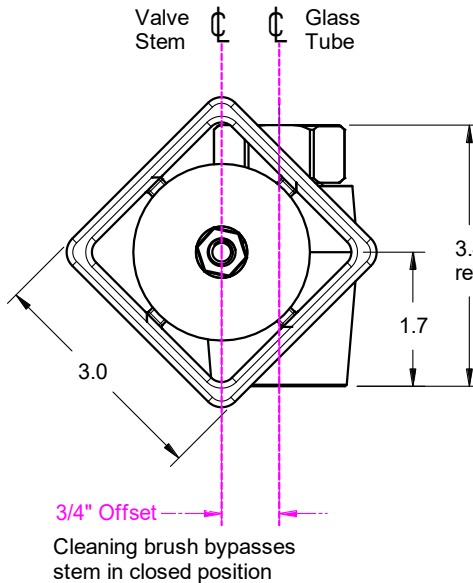
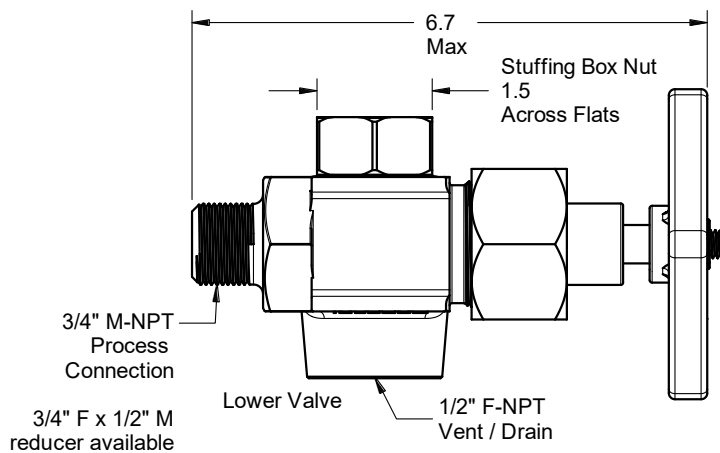
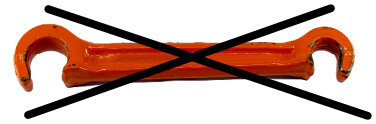

Glass Seal:
 2-208 Viton

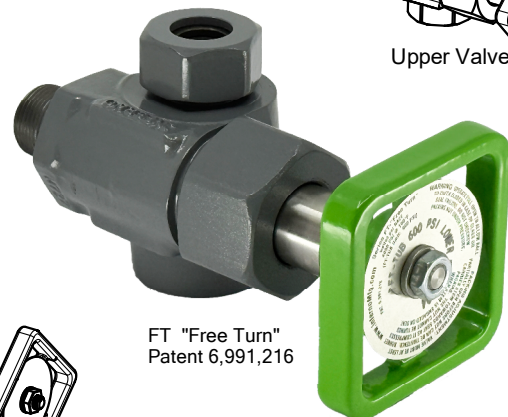
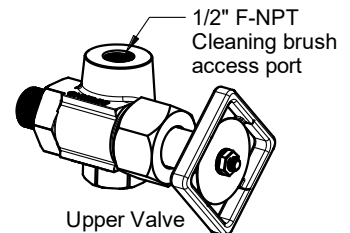
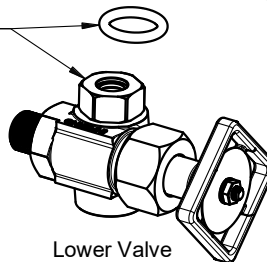

Certified Low-E to 600 PSI @ 392° F,
 limited by glass tube

A105N, A350 LF2, or F316 Construction
 Weight per Set: 10.5 Lbs
 Wetted per NACE MR-0175

* Glass tube cut length and Model TE
 OAL = C-C less 2" ± .125

* Stem packing isolates valve workings from process
 (salt water, H2S etc) [FT "Free Turn" Advantages](#)

* Low emission SS certification tag included

* SKU and Work Order traceability on nameplate



Inferno Manufacturing LLC
 115 Ricou St. Shreveport, LA USA 71107
 (318) 221-8454
inferno@infernomfg.com

Drawing No: **FT-TUB-LE**

Drawing Date: 7/28/2025

Revision: 0

Rev Date: N/A

© 2025 Inferno Mfg LLC

Sheet: 1/1